

Tenth Annual

# Blueberry and Book Festival

Berkshire, New York

**Saturday, July 18, 2026, 9 am to 4 pm**

Rain or shine!

**Outdoor VENDOR Application- space (10 x10) \$20**

**Cash or checks and credit cards payable to Berkshire Free Library**

(Sorry, no refunds due to cancellation)

You should plan on bringing your own table chairs and canopy/tent.

Please note: Beginning this year, you will be given the opportunity to choose your site location when your application is received, so the sooner your paid application is received, the greater site selection will be available to you. See other side for vendor locations.

Please return form with payment no later than **May 1, 2026**, to **Berkshire Free Library, PO Box 151, Berkshire, NY 13736**

Name: \_\_\_\_\_

Address: \_\_\_\_\_

Phone: \_\_\_\_\_ I plan on selling: \_\_\_\_\_

Email: \_\_\_\_\_ Do you require Wi-Fi access for credit card payments? \_\_\_\_\_

Concerns or special considerations: \_\_\_\_\_

Day includes: Variety of Vendors, Puzzles and Paperback Sale, Meet and Greet Local Authors, Lots of Delicious Food, Raffle to benefit Library, Blueberry Pancakes Breakfast and Baked Goods, Live Music throughout the Day, Juried Art Show, Lots of activities for all ages, and many other events still in the planning stages. **Please come join the fun!**

Please plan on staying the entire day ( 9-4). A vendor prize drawing will be held at 3:45 p.m. Must be present to win.

Library policy prohibits dogs from attending any Library event except for service dogs.

Submit this form via email or by mail to: **Janice Merrill, 16 West Hill Road, Richford, NY 13835**

If you have questions, contact : Janice Merrill at 607-657-2587 or merrills1@frontier.com

**Thanks so much for helping us support our local library!**

Credit card payments at: <https://square.link/u/apxW2Fbl>



# Parking

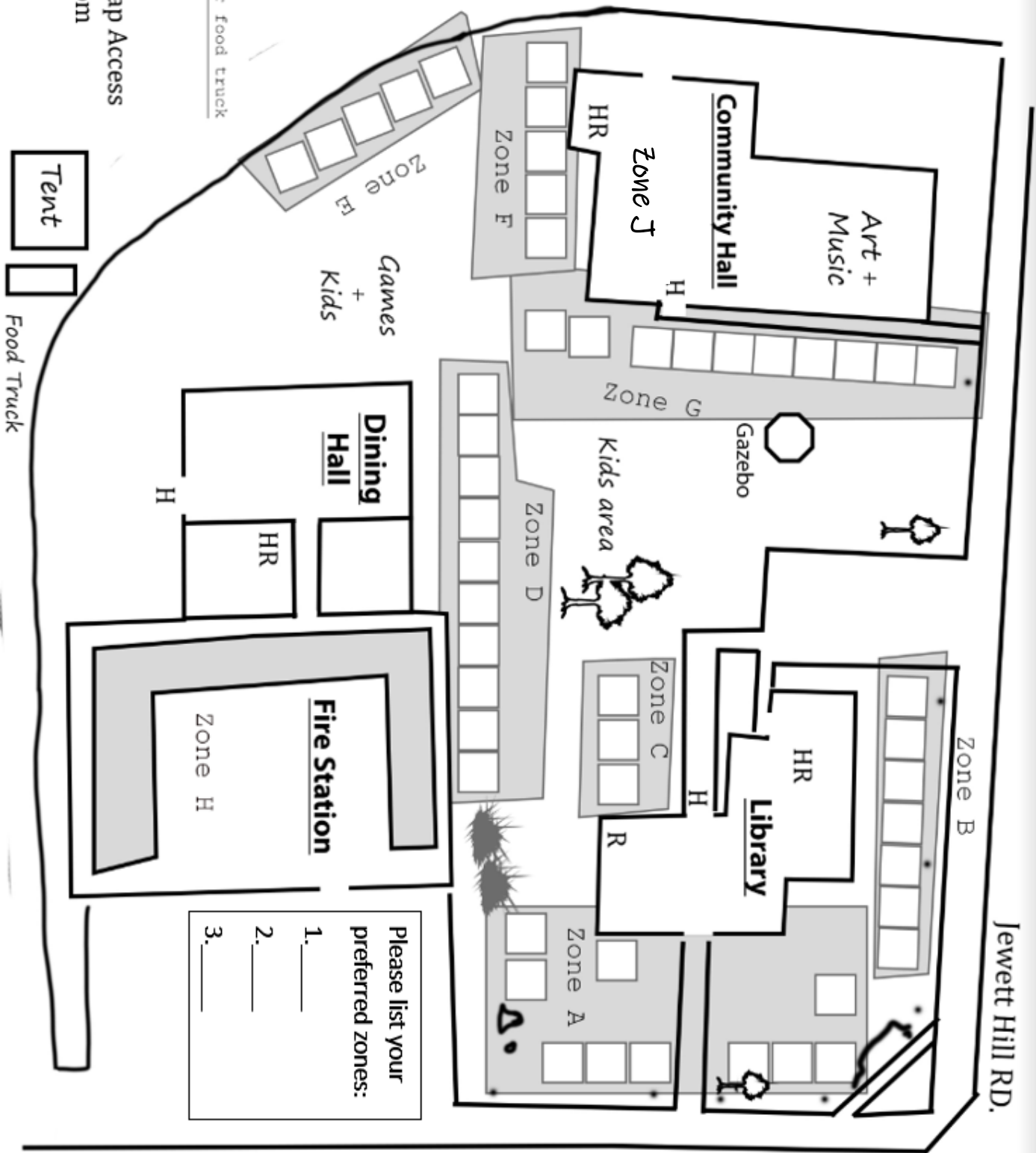

## Zones

- A ~10 spaces
- B 7 spaces
- C 3 spaces
- D ~10 spaces
- E ~5 spaces
- F ~5 spaces or food truck
- G ~10 spaces
- H

H = Handicap Access  
R = Restroom

20ft

Please list your preferred zones:

1. \_\_\_\_\_
2. \_\_\_\_\_
3. \_\_\_\_\_

State Route 38

Jewett Hill RD.